

**NOTICE:** Speed readings are estimates.  
 NOT INTENDED FOR PRECISE  
 MEASUREMENT.

**SPEED FREAK™ ELECTRONIC SPEEDOMETER CAPSULE**

NOTE: DO NOT ALTER LENGTH OF STREAMER

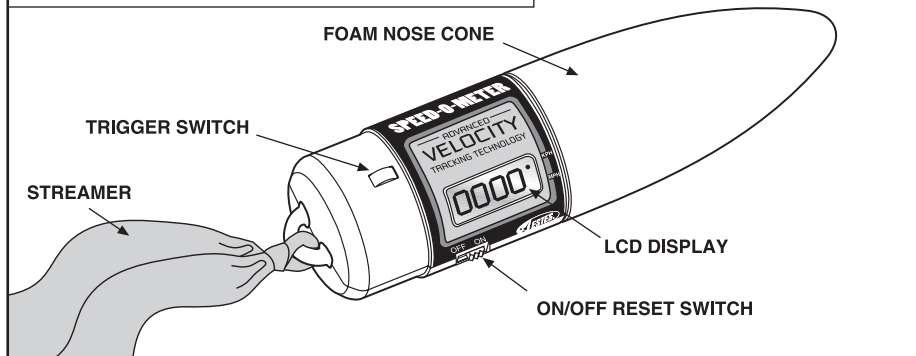

**SUPPLIES REQUIRED**  
 (Not Included)

SMALL PHILLIPS SCREWDRIVER

MASKING TAPE

**1 INSTALL BATTERY**

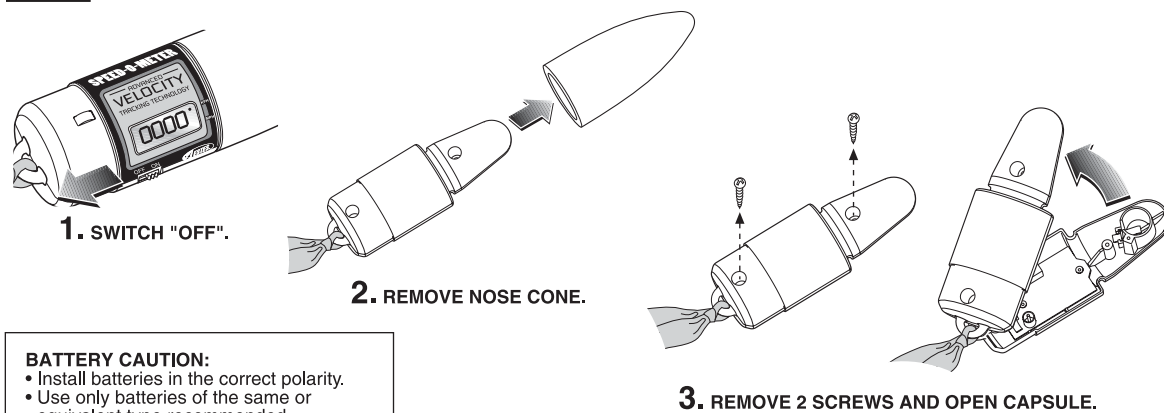

**SPEED FREAK™**  
 Speedometer capsule can operate with the following Estes Rockets: #1811 Tidal Wave, #1825 Patriot, #1827 NSA Starship, #1824 Code Red, or any rocket having an Estes BT-56 body tube.

**BATTERY CAUTION:**

- Install batteries in the correct polarity.
- Use only batteries of the same or equivalent type recommended.
- Do not use rechargeable batteries in capsule.
- Remove old or dead batteries from capsule.

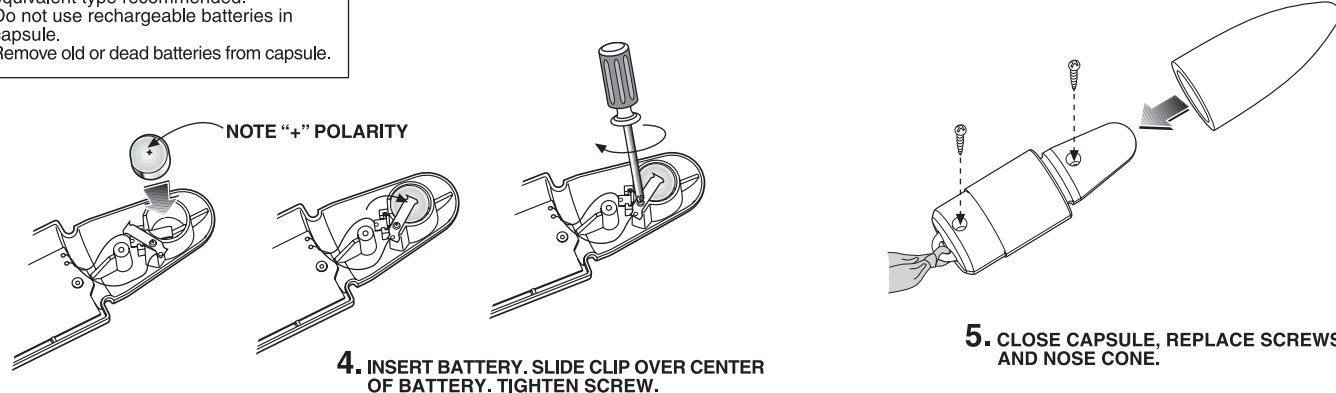

**2 ATTACH THE PARACHUTE**

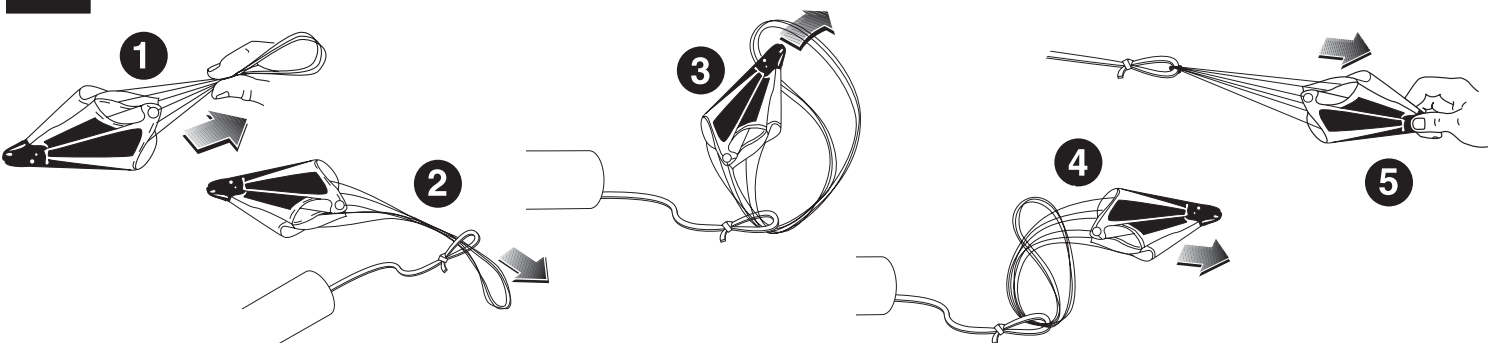

**3 PREPARE PARACHUTE FOR FLIGHT**

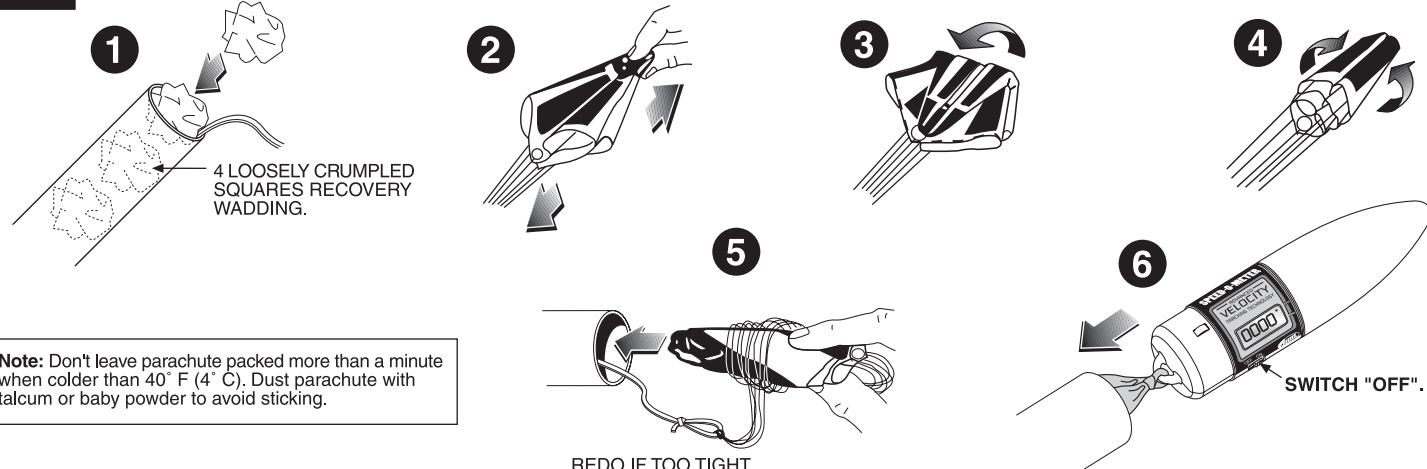

**Note:** Don't leave parachute packed more than a minute when colder than 40° F (4° C). Dust parachute with talcum or baby powder to avoid sticking.

REDO IF TOO TIGHT.

# 4 PREPARE ENGINE

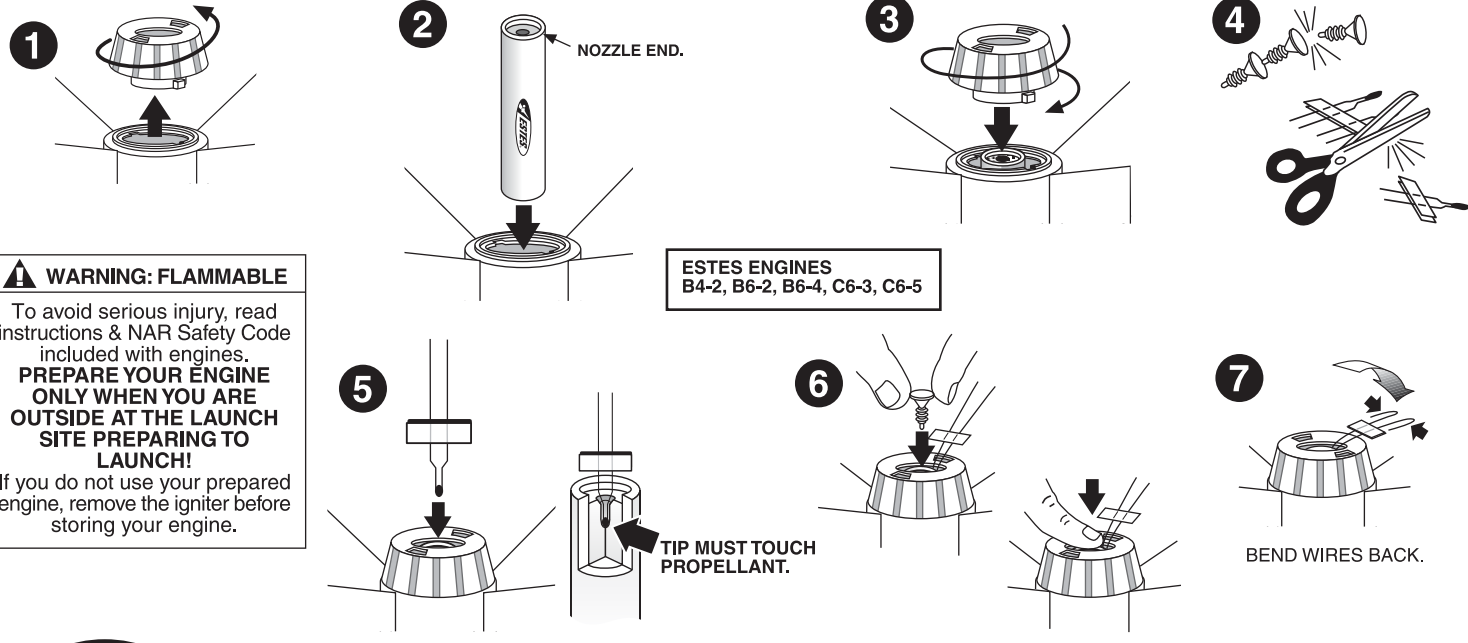

**⚠ WARNING: FLAMMABLE**

To avoid serious injury, read instructions & NAR Safety Code included with engines. **PREPARE YOUR ENGINE ONLY WHEN YOU ARE OUTSIDE AT THE LAUNCH SITE PREPARING TO LAUNCH!** If you do not use your prepared engine, remove the igniter before storing your engine.

## KEY ALWAYS OUT UNTIL FINAL COUNTDOWN!

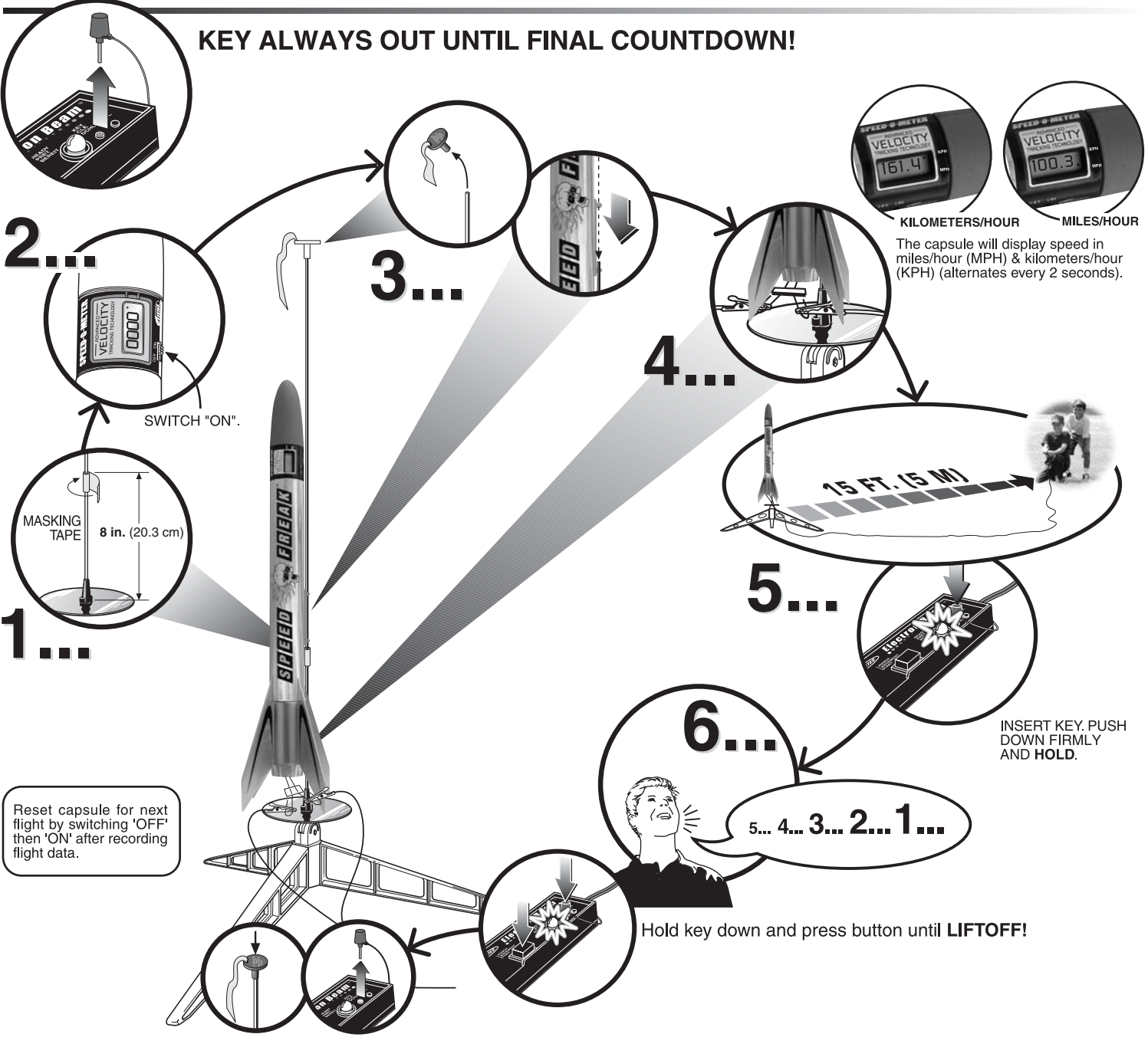

## PRECAUTIONS



## LAUNCHING YOUR ROCKET

Choose a large field (500 ft. [152 m] square) free of dry weeds and brown grass. The larger the launch area, the better your chance of recovering your rocket. Football fields and playgrounds are great. Launch only with little or no wind and good visibility. Always follow the National Association of Rocketry (NAR) Safety Code.

## MISFIRES

TAKE THE KEY OUT OF THE CONTROLLER, WAIT ONE MINUTE BEFORE GOING NEAR THE ROCKET! Disconnect the igniter clips. Take the plug and igniter out of the engine. If the igniter has burned, it worked but did not ignite the engine because it was not touching the propellant inside the engine. Put a new igniter all the way inside the engine without bending it. Push the plug in place. Repeat the steps under Countdown and Launch.